

### H18 HULL/DECK

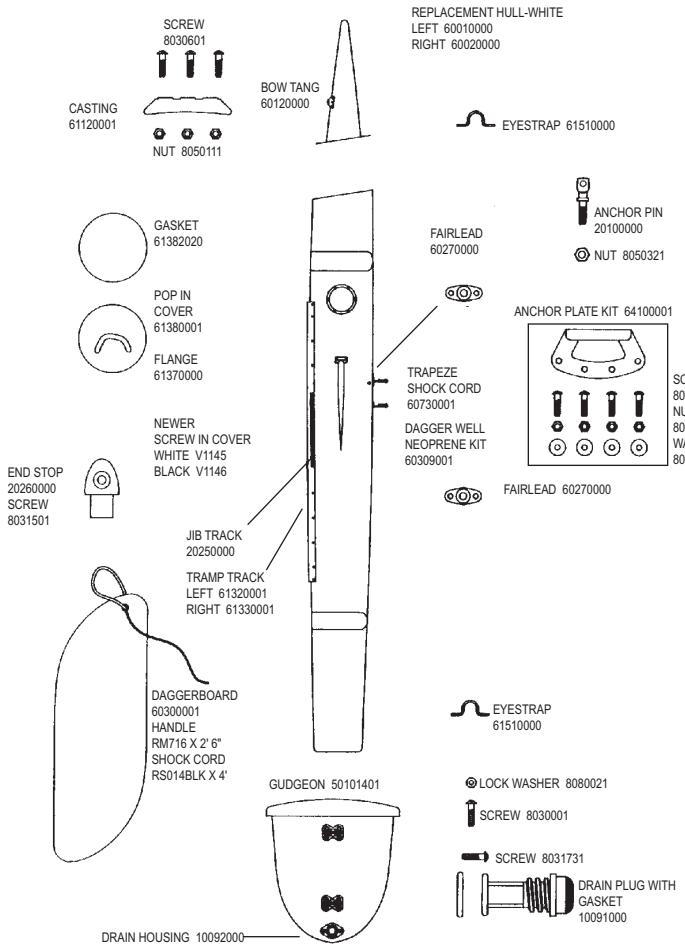

### H18 / H18SX MAST

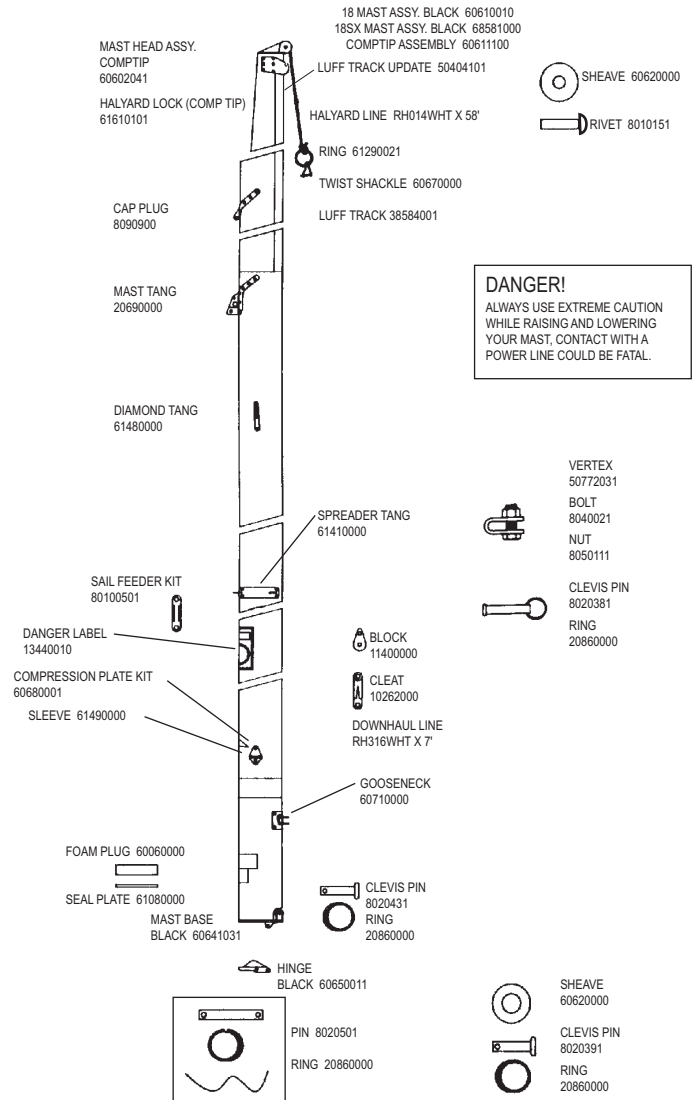

**DANGER!**  
ALWAYS USE EXTREME CAUTION WHILE RAISING AND LOWERING YOUR MAST. CONTACT WITH A POWER LINE COULD BE FATAL.

### H18 SPREADERS

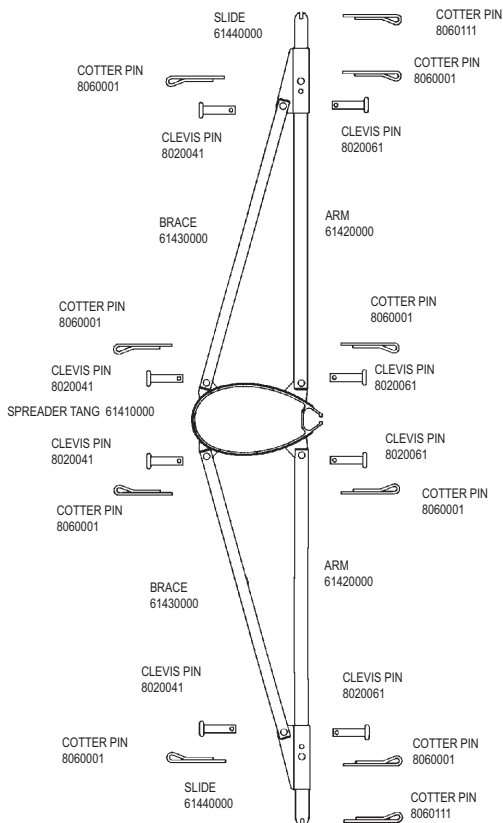

### H18 / H18SX DIAMOND WIRES, ROTATION ARM

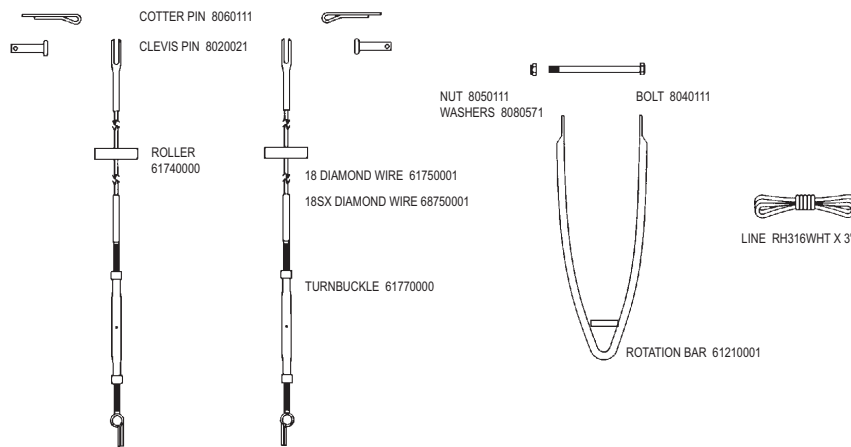

To order from your nearest Hobie Cat dealer  
U.S.A. [hobiecat.com](http://hobiecat.com) 1-800-HOBIE-49  
Australasia [hobiecat.com.au](http://hobiecat.com.au) 1-800-4-Hobie



# H18 / H18SX SHROUDS & ADJUSTERS

# H18 / H18SX FORESTAY & JIB HALYARD

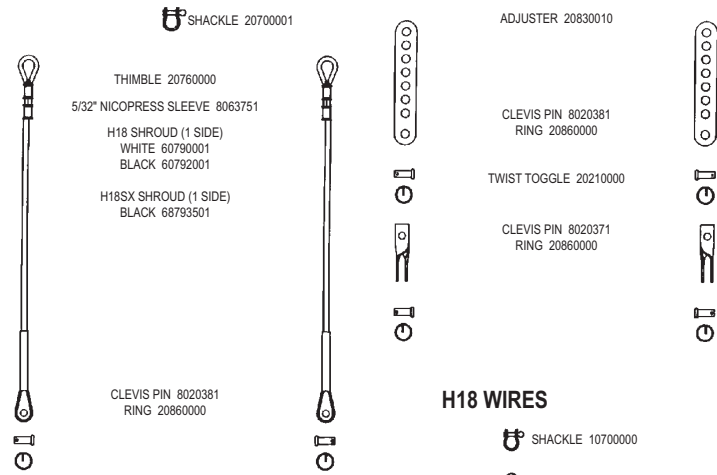

**H18 RIVET GUIDE**

( ) Indicates quantity needed to fasten part.

<b>MAST</b>	
HEAD	8010131 (2)
HALYARD HOOK	8011231 (6)
TANG	8010181 (12)
DIAMOND TANG	8010181 (3)
SPREADER TANG	8010181 (8)
COMPRESSION PLATE	8010181 (4)
GOOSENECK PLATE	8010181 (4)
GOOSENECK CLEAR	8010131 (2)
GOOSENECK BLOCK	8010131 (2)
BASE	8010131 (2)
(Note: all 8010181 mast rivets require 08011291 rivet caps)	
<b>REAR CROSSBAR</b>	
CORNER CASTING	8011231 (6)
INBOARD SUPPORT	8010131 (2)
SWIVEL JAMMER	8010201 (1)
	8031501 (2)
	8031231 (1)
	8080011 (1)
	8050801 (1)
DEAD EYE	8010181 (4)
<b>HULL</b>	
TRAMPOLINE TRACK (backup washers required on above, 61360000)	8010121 (9)
ACCESS PORT FLANGE	8010141 (12)
EYE STRAP	8010131 (2)
<b>BOOM</b>	
END CAP	8010131 (2)
<b>FRONT CROSSBAR</b>	
MAST STEP	8010131 (4)
INBOARD SUPPORT	8010131 (2)
JAM CLEAT	8010181 (2)
<b>RUDDER (UPPER CASTING)</b>	
CASTING	8011231 (3)
END CAP	8010131 (2)
<b>SAIL HARDWARE</b>	
HEADBOARD	8010020 (16)
MAIN CLEW PLATE	8010020 (10)
BATTEN POCKET	8010020 (4)
JIB CLEW PLATE	8010020 (6)
(above rivets requires setting machine which is not available in a hand tool.)	

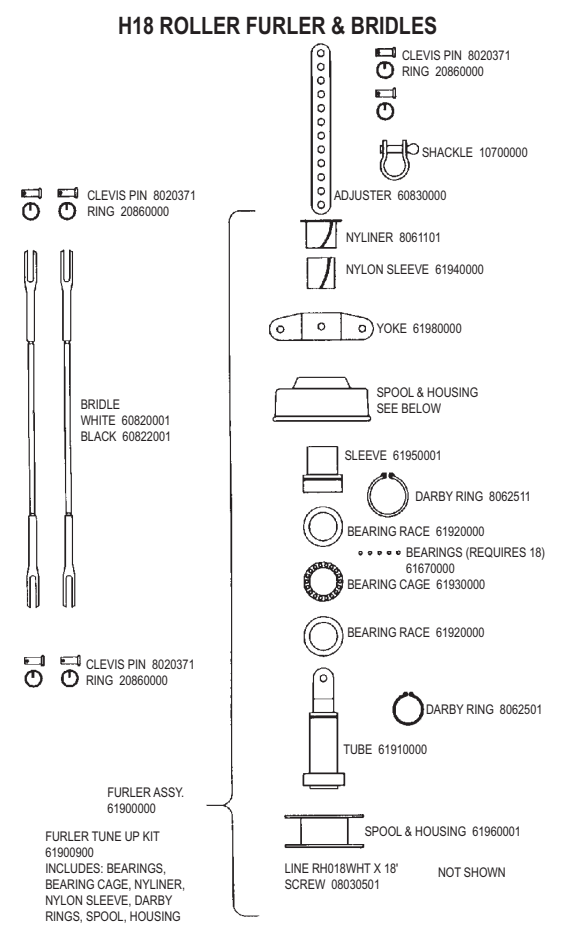
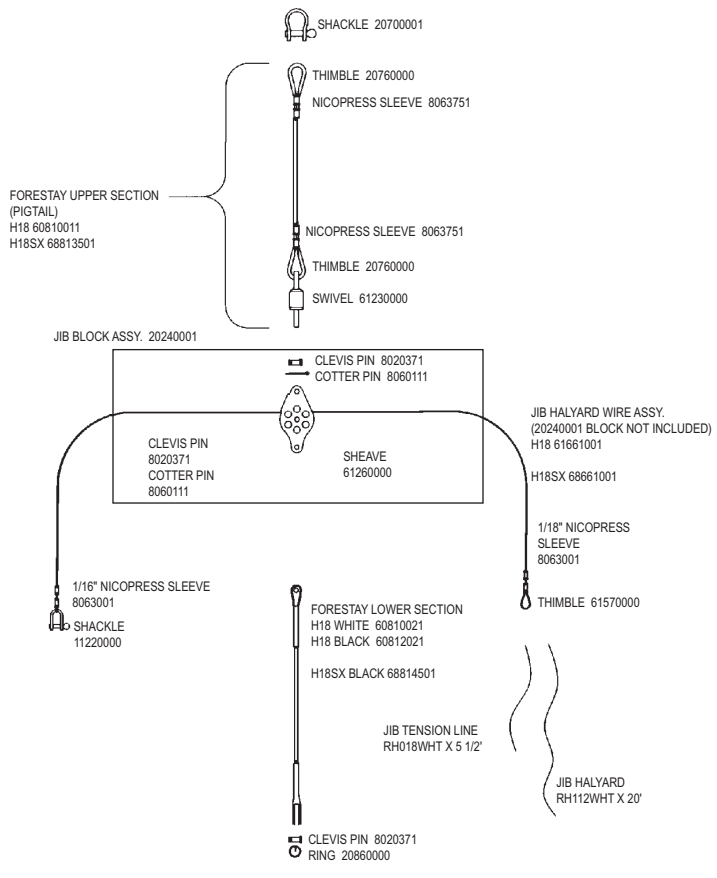
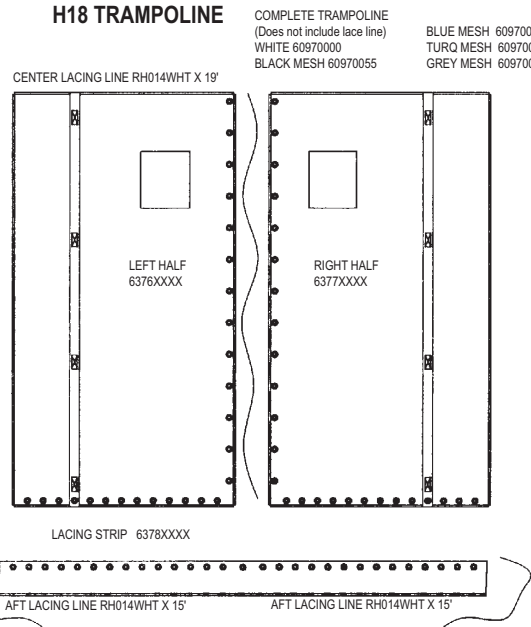
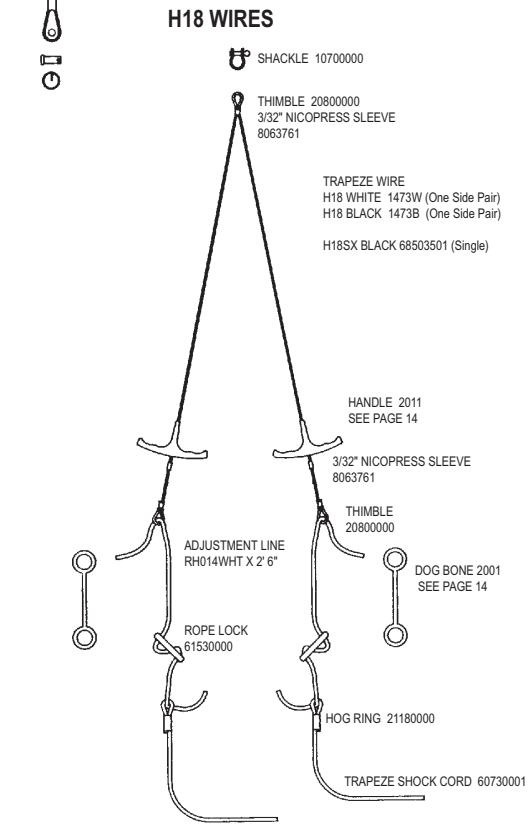

### H18 FWD CROSSBAR

CROSSBAR WITH STEP  
BLACK 60132010

NYLON SCREW  
8031031

MAST STEP ASSY.  
BLACK 60180011  
(Includes all parts within this box)  
(Complete assy required for older  
boats with threaded posts / casting)

NYLON SCREW  
8031031

SCREW  
8030211  
WASHER  
8080521  
BEARING  
60110000

MAST STEP CASTING  
BLACK 60170011

LEFT FRONT  
CORNER  
CASTING  
BLACK  
60150011

RIGHT FRONT  
CORNER  
CASTING  
BLACK 60160011

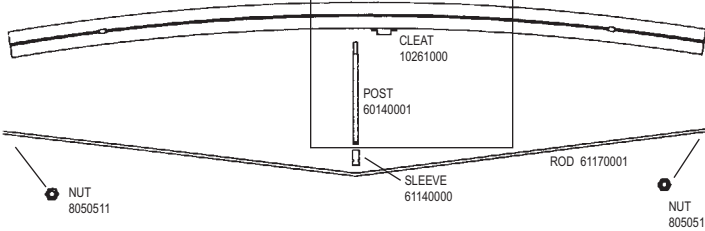

SQUARE NUT, CUSTOM  
61020001

FRONT INBOARD SUPPORT  
CASTING KIT 61010001

LOCK WASHER  
8080581

BOLT 8040561

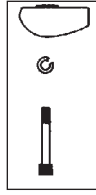
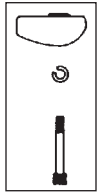

### H18 REAR CROSSBAR

REAR CROSSBAR - EXTRUSION ONLY

BLACK 60191211

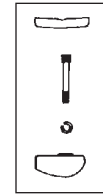

CHANNEL  
61110000  
BOLT  
8040521  
LOCK WASHER  
8080581

REAR INBOARD SUPPORT CASTING KIT 61040001  
(requires 1 per side)

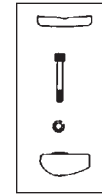

CHANNEL  
61110000  
BOLT  
8040521  
LOCK WASHER  
8080581

CHANNEL  
61110000

CHANNEL  
61110000

NUT  
8050521  
BOLT  
8040501

PAD FOR CAM CLEAT  
1162 SEE PAGE 34

SWIVEL JAM CLEAT  
50007 SEE PAGE 34

LEFT REAR CASTING  
BLACK 60210011

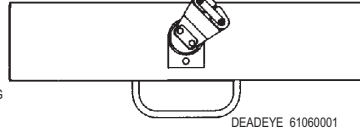

DEADEYE 61060001

NUT  
8050521  
BOLT  
8040501

RIGHT REAR CASTING  
BLACK 60200011

BOLT  
8040501

NUT  
8050521

CHANNEL  
61110000

BOLT  
8040501

NUT  
8050521

CHANNEL  
61110000

### OUTBOARD BOLTS

### H18 BLOCK SET WITH LINE

HARKEN  
H001

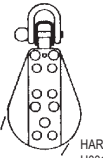
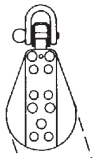

HARKEN  
H001

MAIN SHEET LINE  
RM716XXX X 48'

HARKEN H048

CLEVIS PIN 8020411  
RING 20860000

HARKEN H170

PADEYE 11470000

JIB SHEET BLOCK  
HARKEN 60330041

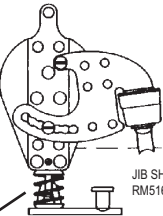

JIB SHEET  
RM516XXX X 44'

MAIN SHEET  
RM716XXX X 48'

SPRING  
H071

SLIDE ONLY  
RF371WSP  
SCREW  
8030711 (2)

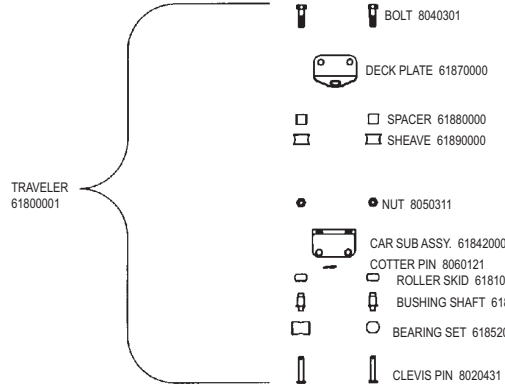

TRAVELER  
61800001

BOLT 8040301

DECK PLATE 61870000

SPACER 61880000  
SHEAVE 61890000

NUT 8050311

CAR SUB ASSY. 61842000

COTTER PIN 8060121  
ROLLER SKID 61810000  
BUSHING SHAFT 61830000

BEARING SET 61852000

CLEVIS PIN 8020431

### H18 BOOM

OUTHHAUL CAR ASSY 60220001 (OUTHHAULAND SHOCK CORD NOT INCLUDED)

CLEVIS PIN 8020381  
COTTER PIN 8060101  
SHEAVE 60620000

CLEVIS PIN 8020391  
RING 20860000

OUTHHAUL CAR  
60220001

BEARING PIN 60250000

BEARING 60240000

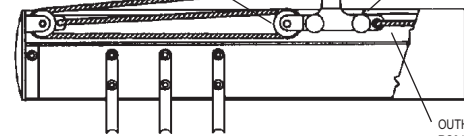

OUTHHAUL SHOCK CORD  
RS014BLK X 7'

CLEAT 61070000  
SCREW 8031011  
CLAMP 61711000

BOOM ASSEMBLY  
BLACK 60720011  
(EXTRUSION NOT SOLD)

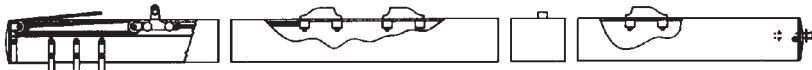

BOOM CAP AFT  
BLACK 60760011  
SHEAVE 60620000  
PIN 60630000

BLOCK HANGER  
10760000

BOOM CAP DRILLED  
BLACK 60751010

BOOM PIN 10772010  
ROLL PIN 50502201

# H18 RUDDER ASSEMBLY

\* = SUB ASSEMBLY PART / INCLUDED WITH CASTING

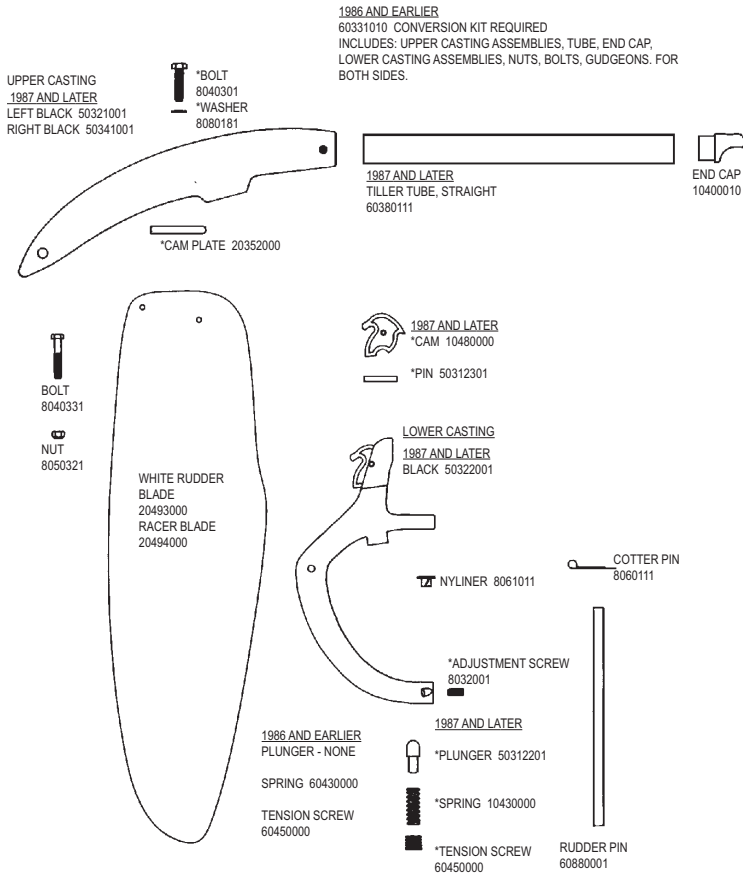

# H18 TILLER CROSSBAR & EXTENSION

TILLER CONNECTOR KIT 11520005

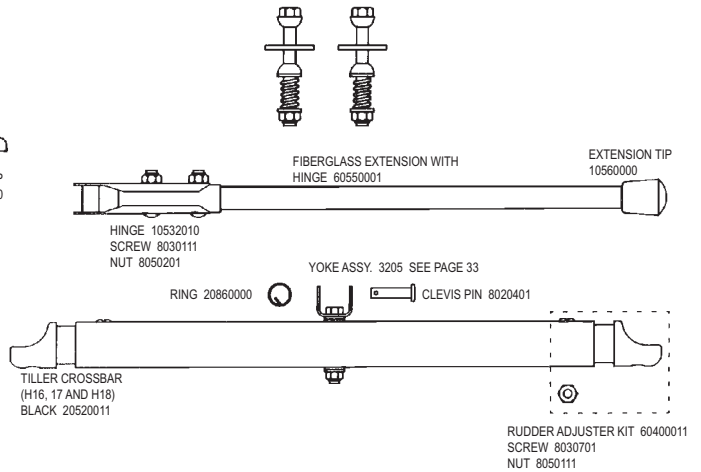

# SX18 WINGS

WING SET W/O TRAMPOLINES 68001000

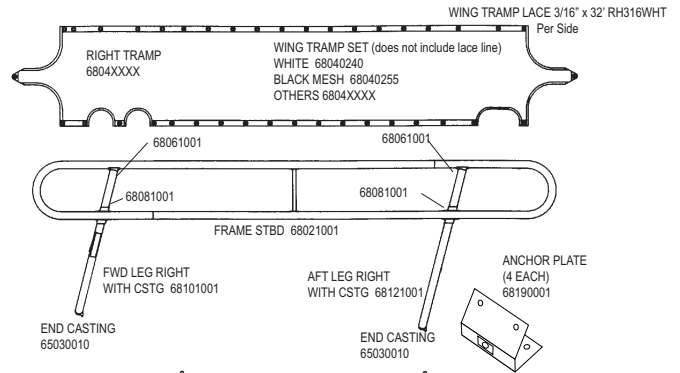

# H18 MAIN SAIL & BATTENS

H18 60991XXX / H18SX 68991XXX  
SEE NUMERICAL SECTION  
OR SAIL COLOR SELECTION SHEETS, PAGE 20

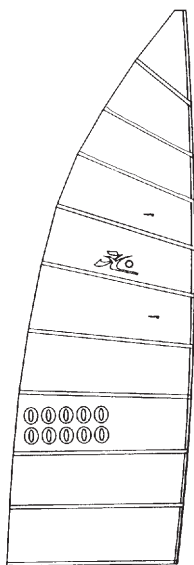
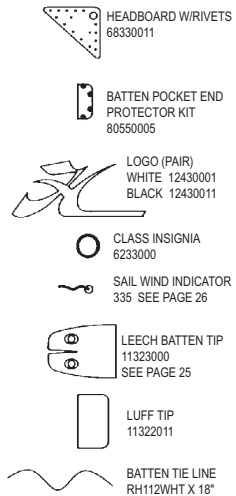

# JIB SAIL

H18 60992XXX  
H18SX 68992XXX

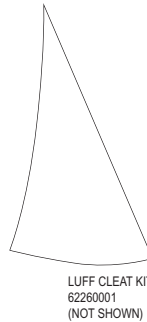

14" SAIL NUMBERS

	BLACK	WHITE
#1	12710030	12710000
#2	12720030	12720000
#3	12730030	12730000
#4	12740030	12740000
#5	12750030	12750000
#6&9	12760030	12760000
#7	12770030	12770000
#8	12780030	12780000
#0	12700030	12700000

MAIN CLEW PLATE-PAIR (W/RIVETS) 62270000

SAIL BAG 21310000

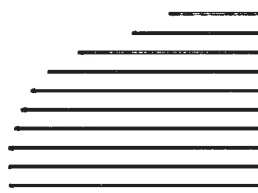

(FOR INDIVIDUAL BATTENS SEE UNIVERSAL BATTENS ON PAGE 25)

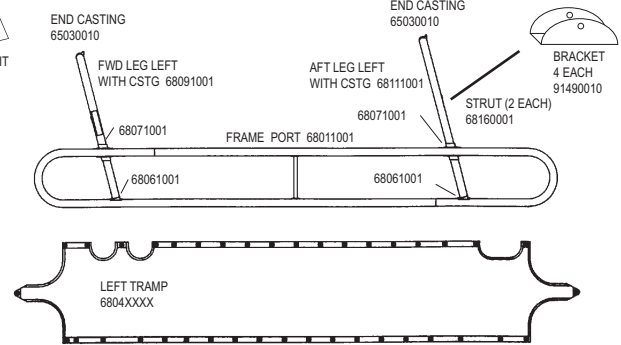
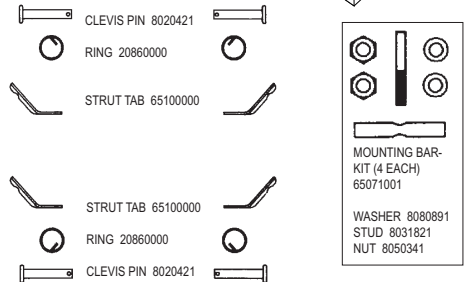

SX WINGS PARTS KIT 68060101 (EVERYTHING EXCEPT WINGS, TRAMPS, LINES AND EXTENSION)